

2022 Autumn Meeting

16 - 18 November 2022

ExCel London and Online (Hybrid Meeting)

Helpful hints:

Attendance

Online: Attendance should be recorded by clicking "Sign in for CPD today" on the event platform each day you attend.

In person: Attendance should be recorded by scanning in at the registration desk using the QR code on your joining email or providing your name.

You will receive a CPD certificate for the live days you have joined online only. Attendance post-event won't be certified but certificates are not required to claim CPD.

Give feedback

Please take the time to fill out feedback after each session. It is mandatory for CPD but also helps us improve our conference and provides invaluable information to our speakers about their presentation.

Visit our sponsors

Challenge yourself - Please review the symposia and spotlight sessions, and consider watching. Spending 5 minutes during the next 3 days to speak to a sponsor.

Contribute

All delegates are encouraged to ask questions for the speakers and panel discussions. If you are thinking it, someone else is too – please send it in via the Ask function on the platform or by a microphone in the room.

For the tweeters @GeriSoc using #BGScnf.

Get Social

Socialise: Chat with attendees, join a socialising event or interact in a group discussion. See the programme for social activities including the return of our Fringe with a special Film Club on Friday

The British Geriatrics Society acknowledges, with grateful thanks, our Sponsors:

Pfizer, AstraZeneca, UCB Pharmaceuticals, Riverstone Living, Abbott Nutrition, Everpharma, Kings College Hospital NHS Foundation Trust and Blackpool Hospitals Teaching Trust

Pfizer and AstraZeneca have provided a sponsorship grant towards this independent Programme. Pfizer and AstraZeneca have had no editorial input into or control over the agenda, content development or choice of speakers, nor opportunity to influence, except for the Pfizer and AstraZeneca sponsored symposia presentations. They have not had any input or influence as to the content of the programme. Sponsored symposia and Spotlight on sessions are not eligible for external CPD and are intended for a healthcare professional audience in the UK.

Start	End	Session title	Details
08:30:00	17:30:00	Registration	In person attendees can register from 08:30. Online attendees should record attendance
09:00:00	17:30:00	Poster presentations Exhibition Area Room 1	View and comment on the posters on-demand via the new BGS Platform All abstracts are published in a supplement for Age and Ageing once the meeting is over. Authors are advised as to what issue this will be in by email. Browse our poster platform and ask questions or make a comment on the posters presented as part of this meeting
09:00:00	17:30:00	Fringe: The History of Geriatric Medicine	It's the year 2122. A visitor at the Science Museum is looking at a display on geriatric medicine over the past 150 years. What objects might they see? Whose voices might they hear? What words might they read? Imagine you are creating a museum display, what would you put on display to represent your experiences of working in geriatric medicine, including during the COVID-19 pandemic? Drop in at 11.00 - 11.30. 13.00 - 14.00 and 15.00 - 15.30 to offer your suggestions as to contents Join Selina Hurley, Curator of Medicine at the Science Museum and Dr Michael Denham at 16.30 for an interactive session and quiz.
		In person only	
09:15:00	10:00:00	Intro and welcome Room 3	Join Dr Jennifer Burns, BGS President opening the 2022 Autumn Meeting Hear from Professor Rowan Harwood, Professor of Palliative and End of Life Care, honorary Consultant Geriatrician, University of Nottingham to celebrate Age and Ageing's 50th Anniversary
10:00:00	11:00:00	Community Geriatrics Session #1 Room 3 Defining working in the community; Training and Workforce Development for an older population Moderators: Dr Philly O'Riordan and Dr Bethan Arnold	10.00 The ACP - development of ACP's and role in the community Rachel Jackson, Consultant practitioner (Frailty and Older people), Wiltshire Health and Care 10.20 The role of the GP in older people's community healthcare Dr Holly Paris, Care Home Hub Service LeadGP, The Pier Health Group, Weston Super Mare 10.40 The Community Geriatrician Dr Julianaa Raghu, OOPE Specialty Doctor, Home Treatment Service West Kent
09:30:00	11:00:00	End of Life Care Session #1 Room 4 Anticipatory Care planning Patient centred decision making in acute illness: "because we can does not always mean we should" Moderators: Dr Eileen Burns and Helen Millbourn	09.35 Patient relative perspective Professor Carl Thompson, Professor Applied Health Research, University of Leeds and Professor Karen Spilsbury, Professor of Nursing University of Leeds 10.05 Is what matters what happens? Dr Saskie Dorman, Consultant in palliative medicine, University Hospitals Dorset 10.25 The Paramedics role in providing good end of life care Jen Scott Green, End of Life Care Lead, and Andy Collen, Consultant Paramedic, South East Coast Ambulance Service NHS Foundation Trust 10.45 Discussion
10:00:00	11:00:00	Green healthcare and sustainability in medicine Room 5/6/7 Moderators: Dr Katrina Davies and Dr Bethan Davies	With the NHS Net Zero commitment, and BGS' own environmental policy join Dr Katrina Davies and colleagues to understand how to engage with this important agenda and to familiarise attendees with the ways they can help to reduce their carbon footprint in the workplace via this initiative. Many members will be considering how they can reduce the environmental impact of the care they deliver. 10.00 Environmental Sustainability and Older people Dr Adrian Hayter, GP Partner Runnymede Medical Practice, National Clinical Director for Older People and Integrated Person Centred Care, NHS England and NHS Improvement 10.15 Green healthcare Dr Katrina Davies, GP, Park Surgery, Solihull 10.45 How ExCel introduced positive sustainability changes across their organisation Natalie Sykes, Sustainability Manager at ExCeL London

Start	End	Session title	Details
11:00:00	11:30:00	Free time	Grab a drink, do a quick walk or join the Fringe for a break, stretch or just a relax. There will be regular non-educational sessions throughout the meeting. See the Fringe Programme for more details
11:30:00	13:00:00	Community Geriatrics Session #2 Room 3 Overprescribing and deprescribing Moderators: Dr Liz Lawn and Esther Clift	11.30 Green Prescribing in older people's healthcare Professor Anthony J Avery OBE, GP and Professor of Primary Health Care National Clinical Director for Prescribing, NHS England 11.50 Polypharmacy Project "Show me your meds" Dr Deb Gompertz, Complex Care GP, Yeovil Hospital 12.10 Deprescribing approaches with older people Ms Anne Bentley, Lead Pharmacist, Digital Care Hub, Airedale NHS Foundation Trust 12.30 Safer, optimal, and greener prescribing Discussion
11:30:00	13:00:00	End of Life Care Session #2 Room 4 End of life in the Community Anticipatory Care Moderators: Dr Lucy Pollock and Dr Sarah Hopkins	11.30 Missed opportunities Video vignettes describing opportunities to engage with patients about anticipatory care. 11.40 What matters to me Dr Catherine Millington Sanders, RCGP & Marie Curie National Clinical Champion for End of Life Care, RCGP & Marie Curie National Clinical Champion for End of Life Care 12.00 Planning ahead Dr Alexis Paton, Lecturer in social epidemiology Co-Director, Centre for Health and Society, Aston University 12.20 Taking a small country approach to anticipatory care planning - Northern Ireland's experience Dr Mark Roberts, Consultant Older People's Medicine, Western HSC Trust 12.40 Reflection on talks Dr Lucy Pollock, Consultant Geriatrician, Taunton & Somerset NHST
11:30:00	13:00:00	Equality and Diversity, Inclusivity in Geriatric Medicine Rooms 5,6,7 Workshop Moderators: Dr Jenny Burns and Dr Moe Thaw Oo	11.30 Beyond Inclusivity Dr. Moe Thaw Oo Consultant Geriatrician with a special interest in Parkinson's disease and Foundation Year 2 Programme Director, Sandwell and West Birmingham Hospitals NHS 11.45 Doctors are disabled and have chronic health conditions too - what can we do? Dr Kirsty Colquhoun, Consultant Geriatrician, Glasgow Royal Infirmary 12.00 EDI experiences in medical students and training Dr Julie Dovey, Consultant in Medicine for Older People, University Hospitals Bristol NHS Foundation Trust

Start	End	Session title	Details
13:00:00	14:00:00	Lunch	Lunch break and Exhibition
13:30:00	14:00:00	Sponsored Symposium Room 3 This is a promotional symposium sponsored and organised by AstraZeneca	Identifying and managing Chronic Hyperkalaemia Dr Kate Bramham, Consultant Nephrologist, King's College London Not eligible for external CPD AstraZeneca has provided a sponsorship grant towards this independent Programme. AstraZeneca has had no editorial input into or control over the agenda, content development or choice of speakers, nor opportunity to influence except for the AstraZeneca sponsored symposia presentations.
14:00:00	15:00:00	Community Geriatrics Session #3 Room 3 Virtual Wards and Frailty Moderators: Dr Liz Lawn, Dr Eva Kalmus and Dr Mohamed Elok	Examples of virtual wards around the UK 14.00 Overview of the virtual ward model Dr Shelagh O'Riordan, Consultant Community Geriatrician, Clinical Director for Frailty in East Kent and Professional Advisor to NHSEI on Aging Well Programme, Kent Community Health NHS FT 14.15 BHFT Virtual Ward Catherine Bell, Pharmacist Virtual Ward Team and Andrea Allanach, Lead ANP, Bradford Teaching Hospitals NHS Foundation Trust 14.30 Somerset Virtual Ward Case Study Fiona Green, Advanced Clinical Practitioner - Frailty, Somerset NHS Foundation Trust 14.45 Virtual Respiratory Wards Case Study Dr Catherine Monaghan, CD for Out of Hospital Care Clinical Lead Care Group One, North Tees and Hartlepool NHS Foundation Trust
14:00:00	15:00:00	End of Life Care Session #3 End of life care and complex mental health problems Room 4 Moderators: Dr Peter Cutajar and Dr Roy Soiza	14.00 End of life care for older people with psychosis Prof Rowan Harwood, Professor of Palliative and End of Life Care, honorary Consultant Geriatrician, University of Nottingham 14.30 End of life care and complex mental health problems Professor Liz Sampson, University College London and North Middlesex University Hospital
14:00:00	15:00:00	Quality Improvement clinic Rooms 5,6,7 Workshop Moderators: Dr Susan Went, Dr Sangam Malani, Dr Rachel Melrose and Dr Tom Barlett	This workshop is designed to support attendees to develop their understanding of the processes involved in quality improvement and seek one to one advice on furthering a project they are working on. We will showcase existing pieces of QI work to discuss in the workshop. We aim to discuss the nature and purpose of quality improvement, the stages of QI methodology, and the steps for ensuring effective QI supervision. We encourage all grades who wish to improve their QI skills to attend. Dr Susan Went, Managing Director, Nerissa Healthcare Consulting Ltd.; Dr Sangam Malani, Registrar in Geriatric Medicine, Hillingdon Hospital; Dr Tom Barlett, Consultant Geriatrician, Poole Hospital NHS Foundation Trust; Dr Rachel Melrose, ST7 registrar, Hull Royal Infirmary 14.00 Introduction of the QI Hub and Discussion 14.30 Platform Presentation- Abstract no 1226 -A multi-disciplinary approach to transforming eye care services for care home residents, 2 N Ma1; S Low1; S Hasan2; A Lawal2; S Patel3; K Nurse4; G McNaughton4; R Aggarwal4; J Evans5; R Koria5; C Lam11; M Chakravorty1; G Stanley2; S Banna1; T Kalsi1,4 14.45 Platform Presentation – Abstract no 1257-Improving hydration in elderly patients on outlier wards at Newham University Hospital (NUH), C R E D Smith1; S Aziz1; S V Duper1
15:00:00	15:30:00	Free time	Grab a drink, do a quick walk or join the Fringe for a break, stretch or just a relax. There will be regular non-educational sessions throughout the meeting. See the Fringe Programme for more details

Start	End	Session title	Details
15:30:00	16:30:00	Community Geriatrics Session #4 Community Clinics and Care Homes Room 3 Moderators: Dr Holly Paris and Dr Alasdair Macrae	15.30 Importance of Social Care – the relationship between health and social care for good preventative and rehabilitative care Liz Jones, Policy Director, National Care Forum 16.00 Beyond Social Prescribing: The Third Sector as Healthcare Providers Iain Cassidy, CEO; Bee Burgess, Head of Outreach & Support Services and Deryn Bath, Head of Physical Activity at Open Age
15:30:00	16:30:00	End of Life Care Session #4 End of life care and complex mental health problems Room 4 Moderators: Dr Sarah Wilson and Nicky Hayes	Cases for discussion Led by Dr Sarah Wilson, Consultant Old Age Liaison Psychiatrist, Nottingham Prof Rowan Harwood, Professor of Palliative and End of Life Care, honorary Consultant Geriatrician, University of Nottingham Dr Peter Cutajar, Consultant Psychiatrist, Highbury Hospital Nottingham Professor Liz Sampson, University College London and North Middlesex University 16.20 End of Life Care SIG business meeting
16:00:00	17:30:00	Nurse and Allied Health Professionals Communities of Practice Meeting Room 5, 6, 7 Dr Esther Clift	Research Focused Community of Practice Hear from Dr Susanne Arnold Register here to attend online if not attending the meeting in person
16:30:00	17:00:00	Fringe: History of Geriatric Medicine live presentation and quiz Room 2 Fringe	Join Selina Hurley and Mike Denham in this live presentation and quiz on the history of geriatric medicine and building the museum of the future to showcase Geriatric Medicine
16:30:00	17:00:00	Sponsored Symposium Room 3 This is a promotional symposium sponsored and organised by Riverstone Living	Sponsored by Riverstone Living Move and Groove: An intergenerational programme using the power of music and sport to impact connection, physical health, and mental wellbeing Charlotte Miller, Director of Intergenerational Music Making, Clinical Early Intervention Specialist Music Therapist, NHS Introduced by: Dr Zoe Wyrko, Wellbeing Director, Riverstone Not eligible for external CPD



Tweet @GeriSoc and use #BGSCConf

Start	End	Session title	Details
08:00:00	09:00:00	Nurses and AHP Breakfast Room 5,6,7	The Nurses and AHPs Council welcomes any nurses or AHPs to attend a breakfast meeting to hear about the work of the council and meet with like-minded colleagues. There will be a short presentation followed by an opportunity to talk informally with other clinicians about the BGS's work and learn how you can become more involved with improving healthcare for older people. Register on Zoom here if attending online
09:00:00	17:30:00	Platform and poster presentations Exhibition Area Room 1	View and comment on the posters on-demand via the new BGS Platform All abstracts are published in a supplement for Age and Ageing once the meeting is over. Authors are advised as to what issue this will be in by email. Browse our poster platform and ask questions or make a comment on the posters presented as part of this meeting
09:00:00	09:30:00	Policy breakfast session Rooms 5,6,7	Policy quiz! Join our Policy Manager Sally Greenbrook for an interactive policy quiz. This will be a fun, light-hearted way to learn about health policy affecting older people's healthcare across the UK and BGS's work in this area. Suitable for both old-hands and policy newcomers.
In person only	09:30:00	Exercise and movement session Supercharge Your Focus! Seated Breath & Yoga Fix Room 2 Fringe	We'll be running workout and meditation sessions to get your mind and body ready to engage with our presenters Drop in to this inclusive session to learn techniques CEOs, world leaders and Navy Seals use to clear and focus their minds to help them achieve their goals and enjoy super-charged productive days! Led by inspiring London yoga teacher Emily Harding (Founder of The Yeh Yoga Co and as ft in Business Insider, Cosmopolitan, Stylist and more) these morning sessions will include a potent mix of guided meditation, breathwork and seated yoga movements to help you declutter your mind, soothe aches & pains and prepare yourself for an amazing day ahead! Not to be missed!
09:00:00	09:30:00	Social Coffee	Join others for a social coffee or tea, to meet new people or catch up Located in the Exhibition Area
09:30:00	11:00:00	Association of Academic Geriatric Medicine (AAGM) symposium Room 3 Sarcopenia and frailty: understanding mechanisms and developing interventions Moderators: Professor Carolyn Greig and Professor Janet Lord	09:30 Muscle responsiveness to immobilisation and mitigation strategies in older age Professor Bethan Phillips, Professor of Translational Physiology, University of Nottingham 10:00 The physiological frailty phenotype Joe Taylor, University of Nottingham 10:15 Unravelling the Roles of Obesity and Inactivity on Age-Related Sarcopenia Professor Leigh Breen, Associate Professor: Metabolic and Molecular Physiology, University of Birmingham 10:45 Interventions to ameliorate sarcopenia in hospitalised older adults Dr Carly Welch, Consultant Geriatrician, GSTT
09:30:00	11:00:00	Stroke and Cardiovascular Health Session #1 Investigation and Management of risk factors in stroke Room 4 Moderators: Dr Divya Tiwari and Nicky Hayes	09.30 Carotid artery and intracranial stenosis Dr Nick Evans, Clinical Lecturer, University of Cambridge and Cambridge University Hospitals NHS Foundation Trust 10.00 Atrial Fibrillation in Older people Dr Michael Norton, Deputy Medical Director, North East Ambulance Service 10.30 Extended discussion and questions
11:00:00	11:30:00	Free time	Grab a drink, do a quick walk or join the Fringe for a break, stretch or just a relax. There will be regular non-educational sessions throughout the meeting. See the Fringe Programme for more details

Start	End	Session title	Details
11:30:00	13:00:00	<p>Research Session Room 3 Moderators: Dr Rose Penfold and Dr Stephen Lim</p>	<p>11.30 Rising Star award Dr Mary Ni Lochlainn, NIHR Doctoral Fellow and SpR in Geriatric Medicine, South London Deanery</p> <p>11.45 The ART (Ageing Research Translation) of Healthy Ageing Network Professor Miles Witham, Professor of Trials for Older People, Newcastle University; National Speciality Lead for the NIHR Ageing Clinical Research Network, NIHR Newcastle Biomedical Research Centre Professor Rachel Cooper, Professor of Translational Epidemiology, Newcastle University & Professor of Musculoskeletal Epidemiology, Manchester Metropolitan University</p> <p>12.00 Platform Presentations from the top submitted abstracts 12.00 Abstract 1199 Prevention and Treatment of Critical Illness Acquired Weakness in the Elderly C. Costa1, F. Moniati1 12.15 Abstract 1200 Effect of Balance Training After Hip Fracture Surgery: A Systematic Review of Randomized Controlled Studies F. Moniati1; C. Costa1; C. Chatzimatthaiou1; M. Chatzimatthaiou2 12.30 Abstract 1219 Informal Caregivers of People with Parkinsonism in the PRIME-UK Cross-sectional Study E Tenison1; A Cullen1; D Pendry-Brazier1; M D Smith1; Y Ben-Shlomo 1; E J Henderson 1,2 12.45 Abstract 1223 Identifying Scotland's care home population living with dementia - Is data linkage useful? JK Burton1; TJ Quinn 2; M Drelciuc 3</p>
11:30:00	13:00:00	<p>Stroke and Cardiovascular Health Session #2 Investigation and Management of risk factors in stroke Room 4 Moderators: Dr Divya Tiwari and Dr Nicholas Roberts</p>	<p>11.30 Hypertension and management of haemorrhagic stroke Prof Nikola Sprigg, Professor of Stroke Medicine and Stroke Consultant, Nottingham University Hospitals NHS Trust</p> <p>12.00 Hyperlipidaemia (primary and secondary prevention) Professor David Stott , Retired Professor, University of Glasgow</p>
13:00:00	14:00:00	Lunch	Lunch break and Exhibition
13:30:00	14:00:00	<p>Sponsored Symposium Room 3 Sponsored by Pfizer</p>	<p>Sponsored by Pfizer Healthcare advances in COVID-19 Treatment Dr John Bright, Consultant Physician in Acute Medicine / Respiratory Medicine, Manchester Royal Infirmary. Not eligible for external CPD This is a promotional symposium sponsored and organised by Pfizer</p>
14:00:00	15:00:00	<p>Orthogeriatrics Session #1 Room 3 Moderators: Professor Micheal Vassallo and Dr Nan Ma</p>	<p>14.00 Management of foot fractures (conservative and surgical) Mr Matthew Cichero, Consultant Podiatric Surgeon and Specialist in foot and ankle surgery</p> <p>14.30 Fractures in Older People-An Update Professor Opinder Sahota ,Consultant geriatrician, Nottingham Hospital NHS Trust</p>
14:00:00	15:00:00	<p>Stroke and Cardiovascular Health Session #2 Investigation and Management of risk factors in stroke Room 4 Moderators: Dr Divya Tiwari and Dr Nicholas Roberts</p>	<p>14.00 Stroke and antiphospholipid syndrome Arvind Chandratheva, Consultant Neurologist, National Hospital for Neurology and Neurosurgery Queen Square and UCLH</p> <p>14.30 Investigating & Managing risk factors in “young” stroke Dr Linxin Li, Clinical Research Fellow, Nuffield Department of Clinical Neurosciences.</p>
14:00:00	15:00:00	<p>Faecal Continence Room 5, 6 ,7 Workshop Moderators: Dr Fionna Martin and Professor Jugdeep Dhesi</p>	<p>Faecal Continence; The new patient on the ward who is faecally incontinent Prof James Barrett, Consultant Physician at Wirral Hospital and Professor of Healthcare of Older People, Edge Hill University and Professor Susan Moug, Consultant Surgeon and Honorary Clinical Associate Professor, Royal Alexandra Hospital</p>

Start	End	Session title	Details
15:00:00	15:30:00	Free time	Grab a drink, do a quick walk or join the Fringe for a break, stretch or just a relax. There will be regular non-educational sessions throughout the meeting. See the Fringe Programme for more details
15:15:00	15:30:00	Spotlight on Sponsored session Room 3 Sponsored by UCB Pharma Ltd	Prevention of imminent fracture in the postmenopausal woman with severe osteoporosis Dr Tarun Solanki, Consultant Physician in General and Geriatric Medicine at Musgrove Park Hospital, Somerset NHS Foundation Trust This promotional presentation is sponsored and organised by UCB Pharma Ltd (co-promoted by Amgen) and is intended for a UK Healthcare Professional audience only. IE-N-RM-OP-2200008 Date of prep: October 2022 Not eligible for external CPD
15:30:00	16:30:00	Trevor Howell Guest lecture Room 3 Moderators: Professor Adam Gordon	Impact beyond the patient in front of us Join us to hear Professor Finbarr C Martin's Guest lecture. Professor Martin is currently Emeritus Consultant Geriatrician and Professor of Medical Gerontology (King's College London). At Guy's and St Thomas' NHS Trust in London for 32 years, he helped develop and evaluate a broad range of acute and community clinical services for older people. His research was on geriatric syndromes, particularly falls, delirium, frailty, and the applications of CGA in various settings. H-Index 53 (ResearchGate). Professor Martin has served as President, BGS from 2010-12 as well as the President, European Geriatric Medicine Society from 2018-19. He's also the Chair of the Age and Ageing Editorial Board, 2019-. He was also a Non-executive director, NICE 2013-2016 and is a current Member of the WHO Clinical Consortium on Healthy Ageing (2016-).
16:30:00	17:00:00	Sponsored Symposia Room 3 This is a promotional symposium sponsored and organised by AstraZeneca	The MDT approach to optimising cardiorenal care Dr Christopher Young, Consultant Geriatrician, Southampton General Hospital Not eligible for external CPD AstraZeneca has provided a sponsorship grant towards this independent Programme. AstraZeneca has had no editorial input into or control over the agenda, content development or choice of speakers, nor opportunity to influence except for the AstraZeneca sponsored symposia presentations.
17:15:00	18:00:00	Age and Ageing 50th Anniversary Celebratory Drinks Reception Fringe Exhibition Level 3, Room 2	Age and Ageing journal: 50th Anniversary The BGS's official journal, Age and Ageing, celebrates its 50th year in 2022. First published in February 1972, it has since gone on to become the number one international clinical geriatric medicine journal with an impact factor of 12.782. Research and service evaluation have played an important role in the development of our specialty. Age and Ageing has been at the forefront of disseminating this work, publishing high quality, original research, reviews and opinion articles. It publishes across a broad remit, including clinical, health policy, educational and service development, and particularly value papers that will be of interest to clinicians. To mark its half-century the journal commissioned a series of expert commentaries from an impressive list of international clinical leaders who have described the key issues that collectively challenge us and share some of the solutions that have been developed. As part of the celebratory activities we cordially invite all attendees to join us for a drinks reception and to hear from current and past contributors, editors about the past 50 years as well as the future. Drinks and light food will be available and we encourage you to attend, before finishing the conference day and making your own evening dinner and entertainment plans.

In person only

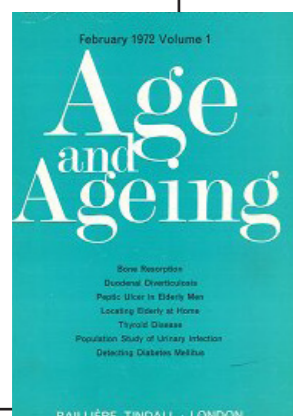

Start	End	Session title	Details
09:00:00	17:30:00	Platform and poster presentations	View and comment on the posters on-demand via the new BGS Platform All abstracts are published in a supplement for Age and Ageing once the meeting is over. Authors are advised as to what issue this will be in by email. Browse our poster platform and ask questions or make a comment on the posters presented as part of this meeting
08:30:00	09:30:00	Exercise and movement session Supercharge Your Focus! Seated Breath & Yoga Fix Room 2 Fringe	We'll be running workout and meditation sessions to get your mind and body ready to engage with our presenters Drop in to this inclusive session to learn techniques CEOs, world leaders and Navy Seals use to clear and focus their minds to help them achieve their goals and enjoy super-charged productive days! Led by inspiring London yoga teacher Emily Harding (Founder of The Yeh Yoga Co and as ft in Business Insider, Cosmopolitan, Stylist and more) these morning sessions will include a potent mix of guided meditation, breathwork and seated yoga movements to help you declutter your mind, soothe aches & pains and prepare yourself for an amazing day ahead! Not to be missed!"
		In person only	
09:00:00	09:30:00	Social Coffee	Join others for a social coffee or tea, to meet new people or catch up Located in the Exhibition Area
09:00:00	09:30:00	Retired member group – Online	Are you retiring from active practice, or have you retired? There is no need to end your relationship with the British Geriatrics Society. There are favourable membership rates for retired members and annual activities for retired BGS members and their partners. Join us online for a catch up and discussion about life in retirement, how to keep involved with the specialty, the BGS as well as colleagues and friends. Please register in advance in Zoom via this link
09:30:00	11:00:00	Platform Presentations Room 3 Moderators: Professor Michael Vassallo and Dr Rose Penfold	09.30 Abstract 1270 Development of a competency framework for early career nurses undertaking post-registration education in care for older people N Hayes1; C Naughton1 09.45 Abstract 1272 A Pilot Routine Electronic Health Record Functional Tracking Score for Older Patients in Hospital L Zioupos1; J Kirkpatrick1; A Anand2 10.00 Abstract 1311 Frailty in randomised controlled trials for dementia or mild cognitive impairment Heather Wightman; Terry Quinn; Frances S Mair; Jim Lewsey; David A McAllister; Peter Hanlon 10.15 Abstract 1321 The association of painful and non-painful comorbidities with frailty. WJ Chaplin1,2,3; HR Lewis1,2,4; S Shahtaheri 1,2,3; BS Millar1,2,3; DF McWilliams1,2,3; JRF Gladman2,3,5; DA Walsh1,2,3,6 Discussion
09:30:00	11:00:00	Endocrine disorders in older people Room 4 Moderators: Dr Alice Wakefield and Professor Jugdeep Dhesi	09.30 Hyperthyroidism overview - pragmatic management and treatment approaches in the frailer population Dr Benjamin Whitelaw, Senior Consultant Endocrinologist and GIM Consultant, King's College Hospital 10.00 Adrenal Insufficiency in Older People Dr Julia Prague, Consultant, Royal Devon and Exeter NHS Trust and University of Exeter
09:30:00	11:00:00	Foot problems in older people Room 5/6/7 Workshop Moderator: Dr Alasdair MacRae	09.30 The rheumatoid foot Dr Lindsey Cherry, Associate Professor & Consultant Podiatrist, University of Southampton & Solent NHS Trust 10.00 Diabetic foot ulcers in the older person Prof. Neil D. Reeves, Faculty Head of Research and Knowledge Exchange (RKE), Manchester Metropolitan University 10.30 General Dermatology in the Older Person from a Lower Leg perspective Dr Bernard Ho, Locum Consultant in Dermatology and Lymphoedema, St George's Hospital, London
11:00:00	11:30:00	Free time	Grab a drink, do a quick walk or join the Fringe for a break, stretch or just a relax. There will be regular non-educational sessions throughout the meeting. See the Fringe Programme for more details

Start	End	Session title	Details
11:00:00	11:30:00	Trainees Meetup Room 5,6,7 Dr Sanham Malani	Join Dr Sangam Malani and the Trainees Council Committee for an update on the work of the Council, to feedback on issues affecting you and suggest future priorities. All in training roles invited to attend. Please register in Zoom for those not attending in person
11:30:00	12:30:00	Service Development Session Room 5,6,7 Moderators: Professor Jugdeep Dhesi and Dr Sangam Malani	Case studies from across the 4 nations highlighting good service development examples. This will include <ul style="list-style-type: none"> Simulation training (Scotland) Dr Julie Mardon, Clinical Director Integration Frailty, Clinical Director Scottish Centre for Simulation and Clinical Human Factors (SCSCHFs) Discharge 2 assess (Wales) Professor Anthony White, Consultant Physician in Medicine for the Elderly, Wrexham Maelor Hospital
11:30:00	12:30:00	Presidential poster round Room 3 Moderators: Dr Jennifer Burns, BGS President and Dr Emily Henderson, VP Research and Academic Development	These are the top abstracts from submissions to the Autumn meeting. They are viewable on demand using the links via the BGS Autumn Meeting page On Friday the President and VP of Research and academic development will review and discuss the Posters with the lead authors. They will be given 3 minutes to summarise their research - you can watch their presentations via the BGS poster platform in advance of this session. Each set of questions takes about 2 -3 minutes and the process is one of support and encouragement. Join live to hear the discussion with authors and more about their research Abstract Supplement Age and Ageing All abstracts are published in a supplement for Age and Ageing once the meeting is over. Authors are advised as to what issue this will be in by email.
11:30:00	12:30:00	Diabetes in older people Room 4 Moderators: Dr Alice Wakefield and Dr Adam Dyer	11.30 Update on Diabetes Medications and Frailty Dr Stuart Ritchie, Consultant Physician, Clinical Director - Edinburgh Centre for Endocrinology and Diabetes and Honorary Clinical Senior Lecturer - University of Edinburgh 12.00 Newer drugs and technologies for the frail older adult with diabetes Dr Marcus Lyall, Consultant Physician in General Medicine/Diabetes and Endocrinology, Royal Infirmary of Edinburgh
12:30:00	13:30:00	Guest lecture Professor Dame Jennifer Harries, Chief Executive, UKHSA Room 3 Moderator: Dr Jennifer Burns, BGS President	The impact of Covid on older people: past, present and future Professor Dame Jenny Harries is the first Chief Executive of the UK Health Security Agency - an executive agency of the Department of Health and Social Care established in October 2021. She leads the agency and is accountable for its strategy and operations, and the effective and efficient use of public funds, with a remit to protect the nation from external hazards to health. Having played central roles in the UK's response to a number of significant public health incidents - including Ebola, Zika, MERS and the Novichok attacks in Salisbury - she was appointed Deputy Chief Medical Officer for England in July 2019 and served through the Covid-19 pandemic until taking up her present role. She is currently overseeing the UK's response to monkeypox.
13:30:00 In person only	14:30:00	Lunch Room 2	Lunch break and Exhibition Special Fringe Film Club Special screening of 'Allelujah' and Q&A with Bally Gill (actor) and Heidi Thomas (writer)
14:30:00	16:00:00	Neurology Room 3 Moderators: Dr Divya Tiwari	14.30 Headaches in older people Dr Salwa Kamourieh, Consultant Neurologist, UCLH 15.00 'Chronic neuropathic' pain in older adults Dr Tacson Fernandez, Consultant in Neuromodulation, Acute & Chronic Pain Medicine and Anaesthesia, RNOH, Honorary Associate Professor, UCL 15.30 Epilepsy in the older adult Dr Divya Tiwari, Consultant Geriatrician, Royal Bournemouth Hospital Foundation Trust and BGS Meetings Secretary
16:00:00	16:15:00	Conference Close	Join Dr Jennifer Burns, outgoing BGS President and Professor Adam Gordon, incoming BGS President to close the 2022 Autumn Meeting

About the speakers

Guest Lecturer



Dame Jennifer Harries, Chief Executive, UKHSA

Professor Dame Jenny Harries is the first Chief Executive of the UK Health Security Agency - an executive agency of the Department of Health and Social Care established in October 2021. She leads the agency and is accountable for its strategy and operations, and the effective and efficient use of public funds, with a remit to protect the nation from external hazards to health.

After medical studies at Birmingham University, UK, she undertook specialist training in Public Health Medicine in Wales. She has wide experience of clinical and public health science and practice, as well as health service commissioning from work in the NHS and in local, regional, and national government. Having played central roles in the UK's response to a number of significant public health incidents - including Ebola, Zika, MERS and the Novichok attacks in Salisbury - she was appointed Deputy Chief Medical Officer for England in July 2019 and served through the Covid-19 pandemic until taking up her present role. She is currently overseeing the UK's response to monkeypox. She has previously served on the UK's Joint Committee for Vaccination and Immunisation (JCVI), and the Expert Advisory Group on the NHS Constitution. Jenny has worked in policy, evaluation and clinical roles in many countries including Pakistan, Albania, India, Brazil and New Zealand.

Trevor Howell

Guest Lecturer

In addition to a medical degree, she holds formal qualifications in pharmacology, business administration, health economics and strategic health service planning.

Professor Martin Finbarr C Martin, Emeritus Consultant Geriatrician and Professor of Medical Gerontology, King's College London).

Professor Martin is currently Emeritus Consultant Geriatrician and Professor of Medical Gerontology (King's College London). At Guy's and St Thomas' NHS Trust in London for 32 years, he helped develop and evaluate a broad range of acute and community clinical services for older people. His research was on geriatric syndromes, particularly falls, delirium, frailty, and the applications of CGA in various settings. H-Index 53 (ResearchGate).

Professor Martin has served as President, BGS from 2010-12 as well as the President, European Geriatric Medicine Society from 2018-19. He's also the Chair of the Age and Ageing Editorial Board, 2019-. He was also a Non-executive director, NICE 2013-2016 and is a current Member of the WHO Clinical Consortium on Healthy Ageing (2016-).



About the speakers

Professor James Barrett Wirral University Teaching Hospital NHS Foundation Trust

Professor James Barrett, is a Consultant Physician at Wirral Hospital and Professor of Healthcare of Older People, Edge Hill University. His Special clinical interests are Stroke medicine, incontinence (especially bowels), memory loss, Parkinsons disease, rehabilitation, Alzheimers disease. His research interests are Incontinence, stroke, falls

Anne Bentley Airedale Telemedicine Hub

I am passionate about improving Patient Safety in Prescribing and Care of Older People. 24 years experience as advanced pharmacist in primary care. As senior lecturer practitioner developed multi-professional NMP Courses. NPC National NMP Prescribing Advisor promoted expansion of NMP. Chaired NICE Guideline Development Group NG 67. Developed Award Winning specialist medicines optimisation in care homes team. Appointed as Consultant Pharmacist (Credential pending) for Older People at Airedale NHS Foundation Trust. Led project since 2018 reducing Anticholinergic and Polypharmacy Prescribing.

Dr Leigh Breen University of Birmingham

Dr Breen's research group are based in the School of Sport, Exercise and Rehabilitation Sciences and work under the auspices of the Medical Research Council/Arthritis Research UK Centre for Musculoskeletal Ageing Research and NIHR Biomedical Research Centre for Inflammation at the University of Birmingham. The overarching goal of his research is to understand cellular mechanisms of skeletal muscle plasticity and develop targeted exercise and nutritional approaches to enhance skeletal muscle remodelling, function and performance in health and disease. His research is fundamentally translational and utilises a range of innovative experimental approaches and techniques, as well as wide-ranging interdisciplinary collaborations to maximize impact and influence. Dr Breen's work is supported by extensive research funding from UKRI, charitable foundations, healthcare bodies and industry partners. He also Leads the UKRI-funded 'ATTAIN' Network for transformative ageing research through addressing health inequality. He has published over 80 peer-reviewed articles and is a regular speaker at national and international conferences.

Dr Lindsey Cherry University of Southampton & Solent NHS Trust

Dr Lindsey Cherry is Associate Professor of personalised care research at the University of Southampton and Consultant Podiatrist with Solent NHS Trust. Lindsey is passionate about supporting people to keep walking, working, and well on their feet.

Dr Kirsty Colquhoun Glasgow Royal Infirmary

Dr Kirsty Colquhoun has been a consultant geriatrician, working in Glasgow, since August 2015. She works across a variety of hospitals, including Glasgow Royal Infirmary, Gartnavel General hospital and The Beatson. In addition she works with Macmillan, developing oncogeriatric services

Dr Julie Dovey University Hospitals Bristol NHS Foundation Trust

Consultant in Medicine for Older People at University Hospitals Bristol and Weston NHS Trust. Interested in medical education, dementia and delirium.

Dr Nicholas Evans University of Cambridge, Cambridge University Hospitals NHS Foundation Trust

Dr Nicholas Evans is a Consultant in Stroke Medicine at Addenbrooke's Hospital and a researcher in cerebrovascular medicine at the University of Cambridge. His research focuses on the imaging of carotid atherosclerosis, drug repurposing for the treatment of atherosclerosis, the link between atheroinflammation and its effects on cerebrovascular disease, and the role of frailty in stroke.

Dr Deborah Gompertz Yeovil hospital Yeovil District Hospital NHS Foundation Trust

I have worked as a Complex Care GP in South Somerset for 6 years after being a GP partner for 13 years. Being a Population Health Fellow for a year has given me the opportunity to look at medication adherence as part of patient centred care.

Professor Carolyn Greig University of Birmingham

Dr Carolyn Greig PhD FPhysiol is Professor of Musculoskeletal Ageing and Health at the University of Birmingham, based in the School of Sport, Exercise and Rehabilitation Sciences. She co-leads the interventions theme for the MRC-Arthritis Research UK Centre for Musculoskeletal Ageing Research (CMAR). In addition she is a member of the UK physical activity guidelines older adults working group. Carolyn is a translational scientist with a long-standing research interest in the design and conduct of studies to maximise the responsiveness of older muscle to physical activity, exercise training and nutritional supplementation, either as single or combined intervention regimens. Her research countering age related loss of muscle mass and function (sarcopenia) and frailty includes diverse groups of older adults, from healthy independent living to frail patient groups

About the speakers

Professor Rowan Harwood **University of Nottingham, Nottingham** **University Hospitals NHS Trust**

Geriatrician for 25 years, working in stroke then delirium and dementia care. Developed model of person-centred acute care. Now Professor of Palliative and End of Life Care

Dr Bernard Ho **St George's Hospital, London**

Dr Bernard Ho is currently a Locum Consultant in Dermatology and Lymphoedema at St George's University Hospital based in Tooting, London
He is a recipient of scholarships and prizes from World Congress of Dermatology, European Academy of Dermatology and Venereology, British Association of Dermatologists, and the Royal Society of Medicine. He has also attended and presented at various international and national Dermatology conferences. He is currently the President of the RSM Trainees Section and Junior Honorary Secretary of the RSM Dermatology Section.

Dr Salwa Kamourieh **UCLH**

Dr. Salwa Kamourieh is a Consultant Neurologist at The National Hospital for Neurology and Neurosurgery, Queen Square, London, UK. She works as part of the Headache and Facial Pain Group. Dr. Kamourieh trained at Imperial College, London and undertook her General Medical and Specialist Training in Northwest London. She completed MRCP in 2010 and a PhD from Imperial College, London in 2016. During her training, Dr. Kamourieh developed an interest in headache disorders. Her specialist areas are primary refractory headaches (chronic migraine, vestibular migraine and trigeminal autonomic cephalalgias) with a specific interest in neurostimulation for intractable headache disorders. Dr. Kamourieh has authored several scientific papers, contributed to book chapters and has been an invited speaker at national medical conferences and teaching courses.

Dr Catherine Millington-Sanders **RCGP & Marie Curie National Clinical** **Champion for End of Life Care**

Dr Catherine Millington-Sanders is RCGP & Marie Curie National End of Life Care Clinical Champion and clinically led the development of the RCGP & Marie Curie Daffodil Standards – UK General Practice Standards for Advanced Serious Illness and End of Life Care. Catherine is Co-Founder and Clinical Lead for the Social Enterprise Difficult Conversations. She is a practising GP, clinical commissioner and educationalist with 7 years experience as a specialty doctor in palliative medicine. Catherine formed and co-chairs the RCGP & Partners EOLC Think Tank that supported development of 'What Matters Most' resources and she chairs RCGP EOLC Advisory Network developing

resources such as RCGP COVID resource hub. Catherine is a co-founder and board member of Compassionate Communities UK supporting Public Health approach to developing Compassionate Communities, implementing the Compassionate City Charter and facilitating the development of compassionate neighbourhoods and supportive networks within our communities. Catherine is a Commissioner for the UK Bereavement Commission.

Dr Mary Ni Lochlainn **South London Deanery**

Mary Ni Lochlainn is a Specialist Registrar in Geriatric and General Internal Medicine, currently completing a NIHR Doctoral Fellowship. She is based at the Department of Twin Research at King's College London and is interested in sarcopenia, frailty and the prevention of age-related disease. Her PhD research is on sarcopenia, and muscle health in older adults, with a particular focus on the role of the gut microbiome in maintaining healthy muscle

She was a co-recipient of this year's Dhole-Eddlestone Memorial Prize from Age & Ageing.

Professor Dr Michael Norton **South Tyneside & Sunderland NHS FT** **& North East Ambulance Service, South** **Tyneside NHS Foundation Trust**

Professor Michael Norton is a Consultant Community Cardiologist and Visiting Professor of Community Cardiology based in the North East of England. Michael runs the Dept. of Community Cardiology in Sunderland. He is also the Deputy Medical Director of the North East Ambulance Service and is clinically active in pre-hospital emergency medicine. Michael has significant experience in syncope and related disorders having worked for over eighteen years (six as head of Department) within the Falls & Syncope Service at Newcastle's Royal Victoria Infirmary. Michael's main clinical and research interests are cardiovascular risk reduction, neuro-cardiovascular syncope and cardiac arrest. He is a director and national council member of the Primary Care Cardiovascular Society. He is a co-founder of Cardioproof, a community interest company, which aims to improve survival from cardiac arrest by increasing bystander CPR and use of public access defibrillators. He is also a co-founder of North East Immediate Care (the BASICS scheme within the North East of England), which provides volunteer pre-hospital critical care support.

Rachel Jackson, Consultant practitioner **Wiltshire Health and Care**

Rachel is a Physiotherapist by profession with a broad experience having worked in Acute, Community and General Practice settings. After initially starting to specialise in Respiratory Physiotherapy she changed direction to now work with the frail and older person

About the speakers

Dr Moe Oo Thaw **Sandwell General Hospital**

Moe is a Consultant Geriatrician and Physician at the Sandwell and West Birmingham Hospitals NHS Trust. He is Deputy Head of Undergraduate Academy in the Trust. He is chair of Inclusion Advisory Group and deputy director of medical examinations at the RCPSG. He is an Honorary Senior Clinical Lecturer and Senior Clinical Examiner at the University of Birmingham. He is a foundation training programme director-careers in HEE, West Midlands
He has read Medicine at University of Medicine 2 Yangon Myanmar and passed the final year examination with a distinction in General Internal Medicine. He has obtained a Master of Medical Science (MMedSc in Geriatric Medicine) from Keele University, England and a Postgraduate Diploma in Clinical Education from the RCPSG. He has also obtained a fellowship in Medical Education (FACadMed) from the Academy of Medical Educators and a fellowship (FFMLM) from Faculty of Medical Leadership and Management. He has published articles, related to Frailty, Parkinson's disease and Clinical Education, in peer-reviewed journals.

Dr Holly Paris **The Pier Health Group, Weston Super Mare**

Dr Paris is Frailty Lead GP in Weston Super Mare, with interests in care homes, and is Clinical Lead for Frailty for BNSSG CCG. She is the lead clinician for 72 care homes, heading up a significant transformation project for Pier Health Group super-practice PCN; a centralised care home hub.

Professor Bethan Phillips **University of Nottingham**

As part of the MRC-Versus Arthritis Centre for Musculoskeletal Ageing Research (CMAR) and the NIHR Nottingham Biomedical Research Centre (BRC), my work focuses on the pathophysiology of musculoskeletal morbidities (sarcopenia, cachexia, arthritis, disuse, metabolic syndrome etc.) and interventions to mitigate their progression and consequences. Combining molecular biology, stable isotope methodologies and detailed in vivo human physiology, I have been a key part of a team that has uncovered fundamental parameters governing alterations in musculoskeletal metabolism with ageing and disease. Latterly, I have also been involved in the application of OMIC technologies to discover predictors of, and the basis for, musculoskeletal and vascular decline in ageing and disease. My current and future focus is aimed at investigating the mechanisms of heterogeneous metabolic and physiological improvements in responses to exercise-for-health interventions and conversely, disuse or inactivity. I also have a strong interest in developing optimal environmental (exercise and nutrition-based) interventions, based around clinical constraints (e.g. time to surgery), to improve physical function in varying clinical cohorts (i.e. colorectal cancer, rheumatoid arthritis). I have significant involvement with aspects of research relating to postgraduate training, research ethics and scientific outreach.

Dr Lucy Pollock **Taunton & Somerset NHST**

I am a geriatrician in Somersets and enjoy my work in care of the frail older person, falls, teaching, ethics and advance care planning with those in care settings, and a small role in research in de-prescribing

Dr Julianaa Raghu **Home Treatment Service West Kent, Kent** **Community Health NHS Foundation Trust**

I am a SE London Geriatric Trainee currently on an OOsPE with the West Kent Home Treatment Service, learning and developing a Community Geriatric Service.

Dr Mark Roberts, Western HSC Trust **Western Health and Social Care Trust**

Lead Consultant Integrated Care, Fermanagh and Omagh region, Western Health and Social Care
My main interests are improving acute and anticipatory care for older adults and narrowing the gap between primary and secondary care teams

Professor Opinder Sahota **Nottingham Hospital NHS Trust** **Nottingham University Hospitals NHS Trust**

Regional/National Appointments:
• Lead Clinician Ortho-Geriatric Medicine NUH
• NIHR HS&DR Researcher Board Member (2013-2017)
• NICE Working Committee (CG 124-2011, QS 16-2012 and CMG 46-2012)
• NICE Falls QS (2014-15)
• NICE Acute Medicine Clinical Guideline Committee (2015-2018)
• ACCEA East Midlands Subcommittee (2017-current)

International Appointments:
• Board member Global Fragility Fracture Network (FFN)
• Chair Vertebral Fracture Specialist Interest Group, FFN

Research interest: vitamin D, muscle function and elderly trauma

National Awards / Recognition:
• Inspirational and Leadership Award, NHS Institute of Innovation and Improvement, 2006
• National BUPA 'Care Award', in recognition for Excellence in the Development of Care for Older People, 2006
• Short-listed finalist HSJ Awards-Implementing NICE guidance, 2007
• Picker Institute Award-Improving patient care, 2010
• National Winner-NHS Leadership Recognition Awards-NHS Leader of the Year, 2012
• Winner NUH Research Impact Award 2015
• HSJ, Health Quality and Safety Awards, National Finalist 2017

About the speakers

Professor Liz Sampson **University College London and North** **Middlesex University Hospital**

I studied medicine at the University of Birmingham, gained my MD from the Institute of Neurology at UCL and completed an MSc in Epidemiology at the London School of Hygiene and Tropical Medicine (2006). I work clinically as a consultant in Liaison Psychiatry (lead for older people) at North Middlesex University Hospital with Barnet Enfield and Haringey Mental Health Trust. I am a member of Royal College of Psychiatrists' Faculty of Liaison Psychiatry Executive Committee (2021)

My research focuses on key clinical issues for frail older people. My main areas of interest are:

- Dementia and delirium in acute hospital patients: Epidemiology and health services research
- Identifying, better understanding and managing common symptoms, including pain, delirium and difficulty swallowing.
- Using mixed methods (data, cohort studies co-design) to implement better care
- Liaison psychiatry for older hospital inpatients

<https://www.ucl.ac.uk/psychiatry/research/marie-curie-palliative-care-research-department/research/centre-dementia-palliative-care>

Professor David Stott **Retired**

David retired in 2019 after 25 years working as the Professor of Geriatric Medicine at the University of Glasgow

He was Editor-in-Chief of Age and Ageing from 2014-19

His research has contributed substantially to the understanding of cognitive decline and disability in later life and to the evidence-base for practice of geriatric medicine and health care of older people and he has over 300 publications in this area, with an h-index of 87. He has continued to publish after his retirement

Dr Carly Welch **Guy's and St Thomas' NHS Foundation Trust**

I am a Consultant Geriatrician at Guy's and St Thomas' NHS Foundation Trust having completed my Higher Specialist Training earlier this year. During my training, I completed a PhD at the University of Birmingham on the subject of acute sarcopenia. I also co-founded the Geriatric Medicine Research Collaborative and was the previous Chair of the BGS Trainees Council.

Dr Sarah Wilson **NUH, Nottingham (Nottinghamshire** **Healthcare NHS Foundation Trust)** **Old Age Liaison Psychiatrist working in** **Nottingham.**

Interests in Dementia, Delirium, Parkinson's Disease and End of Life Care.

Professor Miles Witham **NIHR Newcastle Biomedical Research Centre**

Miles Witham is Professor of Trials for Older People in the NIHR Newcastle Biomedical Research Centre, Newcastle University, and was until recently the national lead for the NIHR Ageing Clinical Research Network. His research centres on clinical trials and other studies to improve physical function and quality of life for older people, with a particular focus on sarcopenia, multimorbidity, cardiovascular disease and kidney disease. He co-leads the ART of Healthy Ageing Network, which aims to catalyse progress in translational ageing research across the lifecourse

Dr Sangam Malani **Hillingdon Hospital**

I am a Specialist Registrar in Elderly Medicine and Chair of the British Geriatrics Society's trainee council. I am passionate about trainees & training and healthy ageing.

As someone born in India, brought up in Thailand and based in the UK, I endeavour to one day share my passions and shape the future of geriatric medicine globally.

Dr Holly Paris **The Pier Health Group, Weston Super Mare**

Dr Paris is Frailty Lead GP in Weston Super Mare, with interests in care homes, and is Clinical Lead for Frailty for BNSSG CCG. She is the lead clinician for 72 care homes, heading up a significant transformation project for Pier Health Group super-practice PCN; a centralised care home hub.

Dr Alexis Paton **Centre for Health and Society, Aston** **University**

Dr Alexis Paton is Director of the Centre for Health and Society at Aston University. She is Chair of the Committee on Ethical Issues in Medicine for the Royal College of Physicians, a trustee of the Institute of Medical Ethics and has been appointed an Apothecary Lecturer by the Worshipful Society of Apothecaries. When not lecturing and researching she can be found writing her column for the Independent on all things related to health, society and ethics.

About the speakers

Dr Adrian Hayter **Runnymede Medical Practice and NHS** **England & NHS Improvement**

Dr Hayter read a Pharmacology degree at Kings College London before starting Medicine at the Royal London Hospital in Whitechapel. He decided to pursue a career in General Practice and continue to work clinical sessions to this day. Dr Hayter visits a care home on one or two sessions a week. He is passionate about the role of GPs not only in the delivery of healthcare but also in leading Health systems by working to improve the health of populations whilst living within the allocated health resources. He became a board member of the Windsor and Ascot Primary Care Group in 1999 and took on a lead role for Older People's Services, developing local falls services and working with the local authority on an Older People's Partnership Board. Other roles include Medical Director for East Berkshire Out of Hours, NHSCC regional representative, Frimley ICS clinical lead in the Integrated Care Decision work stream, the Frailty Advisory Board and the Connected Care Programme.
In October 2019 he was appointed National Clinical Director for Older people and Integrated Person Centred Care, NHS England & NHS Improvement. He is also an NED for Buckinghamshire Healthcare NHS Trust

Dr Jen Scott-Green **South East Coast Ambulance Service NHS** **Foundation Trust**

Jen is a paramedic by background and has worked in various clinical settings, including within Specialist Palliative Care. Her valuable experience within the hospice sector has influenced her leadership journey, bringing End of Life Care confidence and knowledge into the Ambulance Service. She works both locally and nationally on initiatives to improve care within the ambulance service for palliative and end of life care patients.

Natalie Sykes **ExCel, London**

Born in Egypt and raised in the countryside of Wales, Natalie joined ExCeL London as its first full-time Sustainability Manager in 2022, demonstrating the venue's continuing commitment to a net zero future. Having gained a BA in Economics & Politics, she went on to read MSc Environmental Management and started her sustainability career in the construction industry, working for brands such as Berkeley Homes – one of the UK's leading sustainable homebuilders.

Together with being an IEMA Practitioner Member and a qualified BREEAM Site Sustainability Manager, Natalie is ideally placed to lead the business' ESG strategy and expansion programme... not to mention designing an award-winning recycling bin at the age of 13! In her short time at the venue, Natalie has already achieved carbon neutral status for ExCeL becoming the first of its kind in the UK to be awarded the PAS 2060 standard.

Professor Carl Thompson **University of Leeds**

Professor Thompson came to Leeds from the University of York where he was awarded a Personal Chair in Health Sciences in 2009. He is a Professor of Applied Health Research and the Dame Kathleen Raven Chair in Clinical Research. He established the Graduate School in Health Sciences at York and the first Anglo-Dutch MSc in Evidence Based Practice for NMAHPs.

His portfolio of research focuses on healthcare professional and managerial information needs for effective clinical decision making and commissioning. He led the Translating Research into Practice in Leeds and Bradford (TRiPLaB) theme in NIHR ARC for Yorks and Humber version 1.0 and has been part of the implementation science theme in all 3 iterations of the NIHR ARCs in Yorkshire. During the pandemic he led the NIHR's £2m Covid-19 Recovery and Learning (HTA-funded) CONTACT study of digital contact tracing in care homes and worked with colleagues (Prof. Adam Gordon; Prof. Karen Spilbury) to evaluate Point of Care testing for Covid-19 in care homes. As a nurse by background, he has worked in the UK, Romania and the US. He has been a Non-Executive Director of a Foundation NHS Trust and mentored NEDs from other Trusts faced with chairing quality and safety committees. He was co-Editor of the award-winning UK-Canadian BMJ-publishing journal Evidence Based Nursing and is a member of the NIHR HSDR Funding Committee and Irish Health Research Board as well as providing scientific advice to Australian, Canadian, US and Dutch research funders.

He has attracted more than £20m in research, £6m as PI; published 3 books on Decision Making and Judgement and evaluation in healthcare professions; and has more than 120 peer reviewed articles on decision and implementation science, knowledge translation, evidence-based practice, research methods and care homes.

Liz Jones **National Care Forum**

Liz Jones is the Policy Director of the National Care Forum, joining the organisation in May 2019.

Liz has a strong background in social policy, care and support and health and housing, with over 20 years' experience across the civil service, local government and the charity sector including Methodist Homes (MHA), Nottingham City Council and Manchester City Council.

Liz has strong research and analytical skills, along with consultation/engagement skills, and brings with her a passion for ensuring that the voices and views of the people and communities we serve are central to our policy development and implementation.

Liz has a BA honours in English Literature and Language and lives in Nottingham.

About the speakers

Professor Karen Spilsbury University of Leeds

Professor Karen Spilsbury, Chair in Nursing and Academic Director for Nurturing Innovation in Care Home Excellence (NICHE-Leeds), Faculty of Medicine and Health, University of Leeds. Karen is a Professor of Nursing at the University of Leeds (UK) and is Academic Director for NICHE-Leeds, a partnership between care homes and academia that provides the leadership, expertise, and interdisciplinary collaboration that helps care homes innovate efficiently, effectively and sustainably. She leads a portfolio of policy and practice relevant research in the areas of workforce and care for older people: she led the first UK research to quantify and explain how the care home workforce composition and organisation is linked to quality. She is a member of the National Institute for Health and Care Research (NIHR) Applied Research Collaborations (ARC) Yorkshire and Humber Older People and Frailty theme; currently leading research prioritisation to inform the development of interventions for community dwelling older people with frailty. She is a member of the NIHR cross-ARC care home network; working with colleagues to develop, pilot and evaluate a novel Minimum Data Set for UK care homes. Her work is funded by prestigious and competitive research funds; over £20m, with £4m as Principal Investigator. She has contributed to research funding boards and panels (including NIHR Health and Care Delivery Research and NIHR Policy Research Programme; and Irish Health research Board) and has been an Associate Editor for international journals (including the International Journal of Nursing Studies). She was a full member of the Higher Education Funding Council for England's Research Excellence Framework Sub-panel 3 in Allied Health Professions, Dentistry, Nursing and Pharmacy (2021-2022). She has widely published her work (over 100 publications) and is committed to innovative engagement with stakeholders (including policy makers, providers, commissioners, practitioners, regulators and the public) to ensure her research addresses societally important areas and that any outputs are widely accessible.

Mr Matthew Cichero

Matthew is a Consultant Podiatric Surgeon at Great Western Hospital, Swindon. Matthew graduated from Queensland University of Technology (Brisbane, Australia) in 1995 and from Curtin University (Perth) in 2007. Since moving to the UK from Brisbane Australia in 2010, he has overseen the acute diabetic foot co-ordinator role.

He undertakes a full scope of elective foot and ankle reconstructive surgery (except ankle fusions/replacement) as well as limb salvage surgery in the high-risk foot. He is a supervisor for podiatric surgical trainees as well as having student placements for undergraduates to observe

Mr Joseph Taylor University of Nottingham

Final year PhD student at the University of Nottingham, undertaking a project investigating the physiological phenotype

of frailty using multi-modal MRI protocols. Interested in human physiology, ageing, exercise and nutrition.

Dr Salwa Kamourieh UCLH

Dr. Salwa Kamourieh is a Consultant Neurologist at The National Hospital for Neurology and Neurosurgery, Queen Square, London, UK. She works as part of the Headache and Facial Pain Group. Dr. Kamourieh trained at Imperial College, London and undertook her General Medical and Specialist Training in Northwest London. She completed MRCP in 2010 and a PhD from Imperial College, London in 2016. During her training, Dr. Kamourieh developed an interest in headache disorders. Her specialist areas are primary refractory headaches (chronic migraine, vestibular migraine and trigeminal autonomic cephalalgias) with a specific interest in neurostimulation for intractable headache disorders. Dr. Kamourieh has authored several scientific papers, contributed to book chapters and has been an invited speaker at national medical conferences and teaching courses.

Dr Julia Prague Royal Devon and Exeter NHS Trust and University of Exeter

Dr Julia Prague qualified in 2008 from Guy's, King's and St Thomas' School of Medicine with double Distinction and First class Honours. During her PhD at Imperial in reproductive endocrinology she completed the first in human study of a neurokinin 3 receptor antagonist for menopausal flushes, which was published in The Lancet. After finishing her clinical training in Diabetes, Endocrinology, and General Internal Medicine in London she moved to the South West to take up a clinical academic post (50:50 clinical (Diabetes/Endocrinology/GIM):research post) at the Royal Devon and Exeter NHS Foundation Trust and University of Exeter.

Dr Tacson Fernandez RNOH

Dr Tacson Fernandez is an Honorary Associate Professor at University College London, maintaining his research interests and academic collaboration. Dr Fernandez is an interventional chronic pain specialist with core area focus on Neuromodulatory strategies and application across the spectrum of chronic pain indications. Having established the Neuromodulation centre at the RNOH, Dr Fernandez currently engages with research projects on facilitating an understanding of mechanisms of spinal cord stimulators in promoting recovery of patients with complex neuropathic presentations. Dr Fernandez strives to allow patients some respite from their complex pain presentation using cutting edge interventional technologies.

Professor Neil Reeves Manchester Metropolitan University

Neil Reeves is Professor of Musculoskeletal Biomechanics and Director of Research in the Faculty of Science and Engineering at the Manchester Metropolitan University. Prof. Reeves conducts research on clinical movement disorders with a focus on diabetic foot ulcer prevention and gait impairment in diabetes. His research addresses the underlying mechanisms causing gait impairment and unsteadiness in people with diabetes and tests the effectiveness of therapeutic interventions. He has developed and tested medical devices and novel digital technologies aimed at diabetic foot ulcer prevention and gait improvement. His research applies other interventions including exercise for reducing diabetic foot ulcer risk and improving gait and balance in diabetes. Prof. Reeves has published over 130 papers and has an H-Index of 41. He has led research projects supported by European and UK funding bodies. He co-leads a workstream on diabetes within the Manchester 'Cities Changing Diabetes' programme led by Health Innovation Manchester and Novo Nordisk. He is an Editorial Board member for the journal Gerontology and Guest Editor for the journal Sensors.

Dr Stuart Ritchie Edinburgh Centre for Endocrinology and Diabetes

Stuart Ritchie graduated MBChB with commendation, from Glasgow University in 2000, having intercalated in Molecular Biology in 1997 (first class honours). He was awarded MRCP (UK) in 2003, and spent 3 years as a Medical Research Council Clinical Development Fellow from 2004-2007 at the University of Glasgow. Specialist training was completed in the South East Scotland deanery, and in 2011 he was appointed as a consultant in Diabetes and Endocrinology in the Metabolic Unit, Western General Hospital Edinburgh, and is an Honorary Clinical Senior lecturer at Edinburgh University. He is currently Clinical Director for the Edinburgh Centre for Endocrinology and Diabetes.

His clinical interests include inpatient diabetes, antenatal diabetes, pituitary disease and endocrine oncology. He is the coordinator for the South East Scotland region Pituitary MDT.

His research and service developments have focused on inpatient diabetes care, and sits on the Scottish Diabetes Group.

Dr Divya Tiwari Royal Bournemouth Hospital

I am consultant in Geriatric and General Medicine at Royal Bournemouth Hospital since 2009. My clinical interests include old age neurology and Parkinson disease and research interests are towards outcomes research.

Professor Anthony White Wrexham Maelor Hospital

Consultant Physician in Medicine for the Elderly, Wrexham Maelor Hospital, Wrexham. Retired 30 September 2020 but continue to work part-time. Visiting Professor in Geriatric Medicine, Glynd r University, Wrexham.

Recent activities have included:

1. Clinical Investigator COVID-19 Novavax Trial November 2020 to May 2021.
2. Consultant Support to Discharge to Reassess Project from August 2021 to date. I am contracted for 2 sessions or 1 day a week. This is a joint project between BCUHB and Flintshire Social Services, based in a Social Services Care Home (Marleyfield House in Buckley)
3. Undergraduate lectures to Medical Students at Bangor University. Since September 2021 to-date.
4. In collaboration with Glynd r University. Supervision and mentoring of trainee Physiotherapy/Nursing Advanced Practitioners as part of my consultant work at the Discharge to Assess Unit.
5. MRCP PACES examiner.

Previously I have been a Royal College of Physicians Tutor and sat on the local Research Ethics Committee. I have also been – Secretary (2001 to 2005) and Chairman (2007 to 2010) of the British Geriatric Society Cymru Wales.

Dr Ben Whitelaw King's College Hospital

I am a consultant endocrinologist and have worked at King's College Hospital since 2010. My main areas of work are the management of pituitary and adrenal tumours. I also manage patients with thyroid dysfunction and thyroid tumours.

Fringe Room 2

The Fringe Room is a space to refresh, relax and refocus during the conference. Come along and join in an activity, sit a while or catch up with a colleague. This is a space to be utilised as you see best.

Wednesday 16 November All Day
Science Museum for the Future
Drop in at 11.00 - 11.30, 13.00 - 14.00 and 15.00 - 15.30

Join Selina Hurley at 16.30 for an interactive session and quiz

It's the year 2122. A visitor at the Science Museum is looking at a display on geriatric medicine over the past 150 years. What objects might they see? Whose voices might they hear? What words might they read?

Imagine you are creating a museum display, what would you put on display to represent your experiences of working in geriatric medicine, including during the COVID-19 pandemic?



Come and visit the Science Museum booth run by Selina Hurley, Curator of Medicine, with printed out photos of your objects, or come and add words to the mood-board.

Towards the end of the conference sessions on Wednesday 16 November, we will imagine a display, thinking about what it might look like, what common themes there are, and what we'd want people to know. It will be a glimpse into how displays and exhibitions are made.

There will be a chance to virtually explore some of the museum's collection in an object quiz. The Science Museum has world's largest medical galleries featuring more than 3,000 medical artefacts, striking artworks, interactive games and immersive experiences that bring the history of medicine to life. The Science Museum also cares for around 100,000 from Sir Henry Wellcome's museum collection and is constantly adding to their collection.

Come along, be creative, and what you suggest might one day find a home at the Science Museum.

Please join us in Room 2 on Wednesday for this interactive session with any ideas you have.

Thursday 17 November - Friday 18 November
08.30 - 09.30 and Friday 08.30 - 09.30

Exercise and movement session

Supercharge Your Focus! Seated Breath & Yoga Fix

We'll be running workout and meditation sessions to get your mind and body ready to engage with our presenters

Drop in to this inclusive session to learn techniques CEOs, world leaders and Navy Seals use to clear and focus their minds to help them achieve their goals and enjoy super-charged productive days! Led by inspiring London yoga teacher Emily Harding (Founder of The Yeh Yoga Co and as ft in Business Insider, Cosmopolitan, Stylist and more) these morning sessions will include a potent mix of guided meditation, breathwork and seated yoga movements to help you declutter your mind, soothe aches & pains and prepare yourself for an amazing day ahead! Not to be missed!



Fringe Room 2

The Fringe Room is a space to refresh, relax and refocus during the conference. Come along and join in an activity, sit a while or catch up with a colleague. This is a space to be utilised as you see best.

Thursday 17 November 13.00

Social Media session

'Healthcare Twitter for beginners'

We'll be running a drop-in session 'Healthcare Twitter for beginners' which will provide a quick guide to joining the conversation online and avoiding the related pitfalls. This session will be especially relevant for delegates hoping to learn how Twitter can be used to support their education and training, promote their research to wider audiences and grow their professional network. While aimed at beginners, this is an interactive session where other can join to support fellow delegates and/or ask more advance questions during the Q&A. Join Marina Mello, BGS's Communications, PR and Media Manager to learn more.

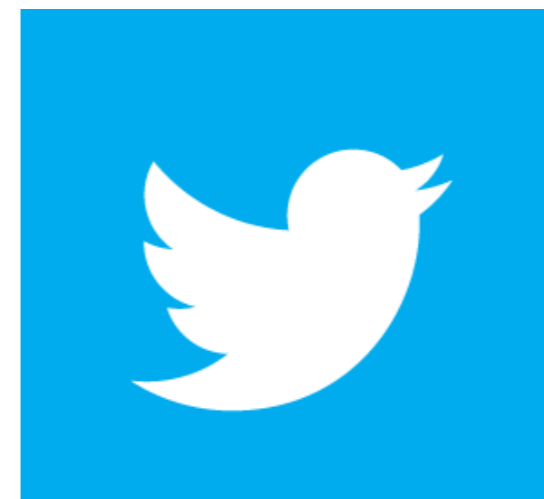

Tweet @GeriSoc and use #BGSCConf

Friday 18 November 13.30 - 14.30

Film club

Special screening of 'Allelujah'

We are delighted to announce there will be a very special Fringe Film Club at this year's BGS Autumn Meeting 2022 on Friday 18 November at 13:30 which will include the screening of exclusive clips of 'Allelujah' ahead of its March 2023 release. Based on Alan Bennett's play, the film is set in the geriatric ward of an overstretched Yorkshire hospital. Actor Bally Gill (right), who plays Dr Valentine, and writer Heidi Thomas, who adapted the play for the big screen, will be in attendance to talk with Dr Khalid Ali about the film and the issues it raises, as well as answering questions from the audience. This session will only be available to delegates attending the Autumn Meeting in person so [register now](#) to join us for this unique Fringe Film Club session!



Please join us in Room 2 on Friday for this interactive session.

British Geriatrics Society Autumn Meeting 2022 Venue overview

- Key*
- Access Route from Prince Regent for ICC London DLR
 - Access route from Custom House DLR
 - Entrance Point (Level 1 Boulevard)

Getting to the Platinum Suite Exit DLR at Custom House

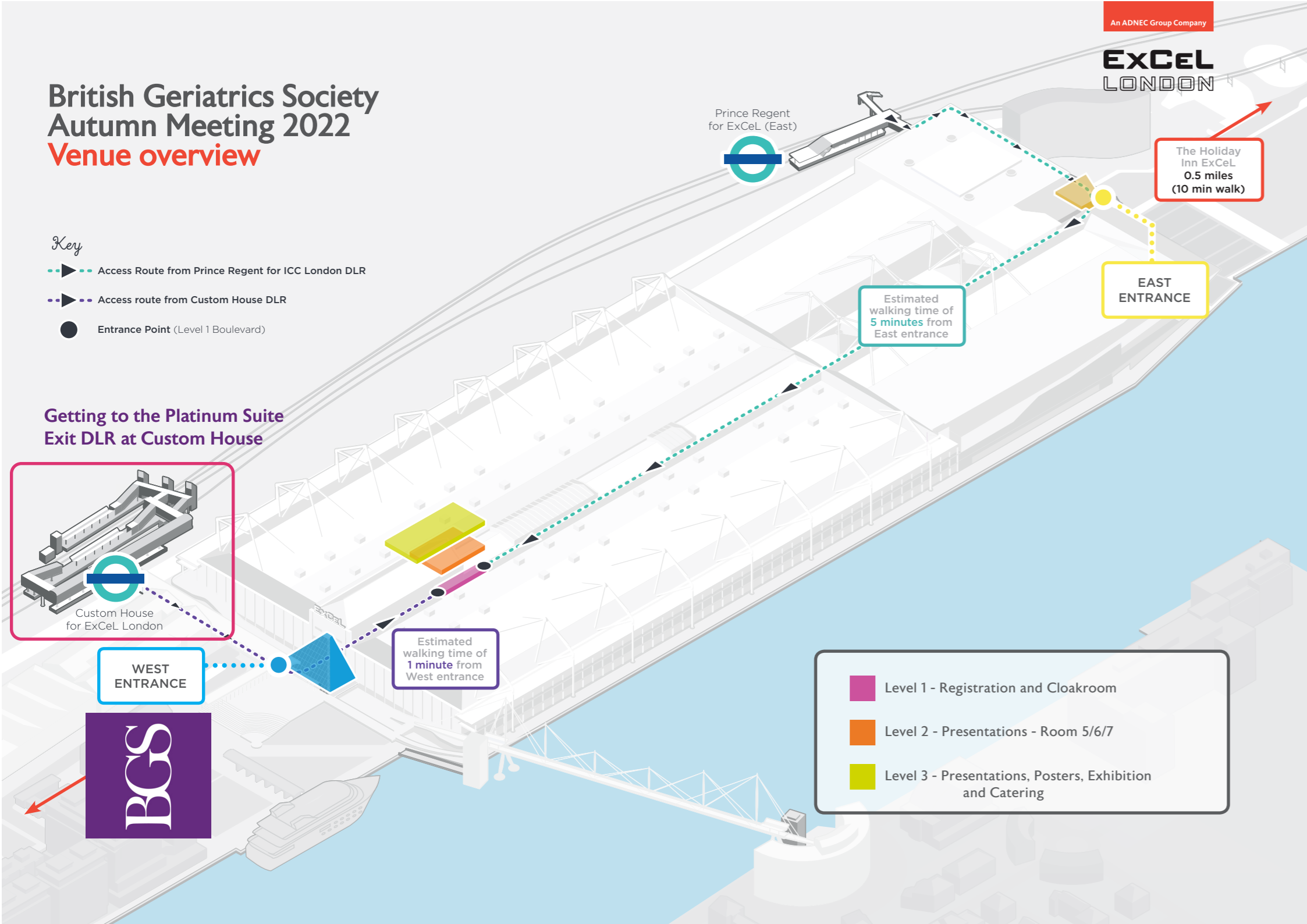
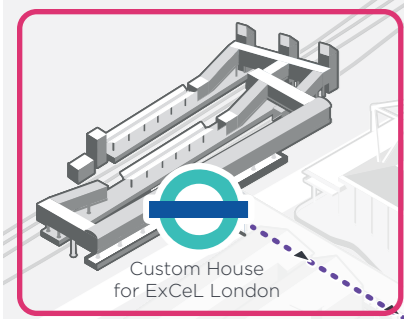

Platinum Suite Level 2

Cloakroom and Presentations

- Cloakroom
- Catering

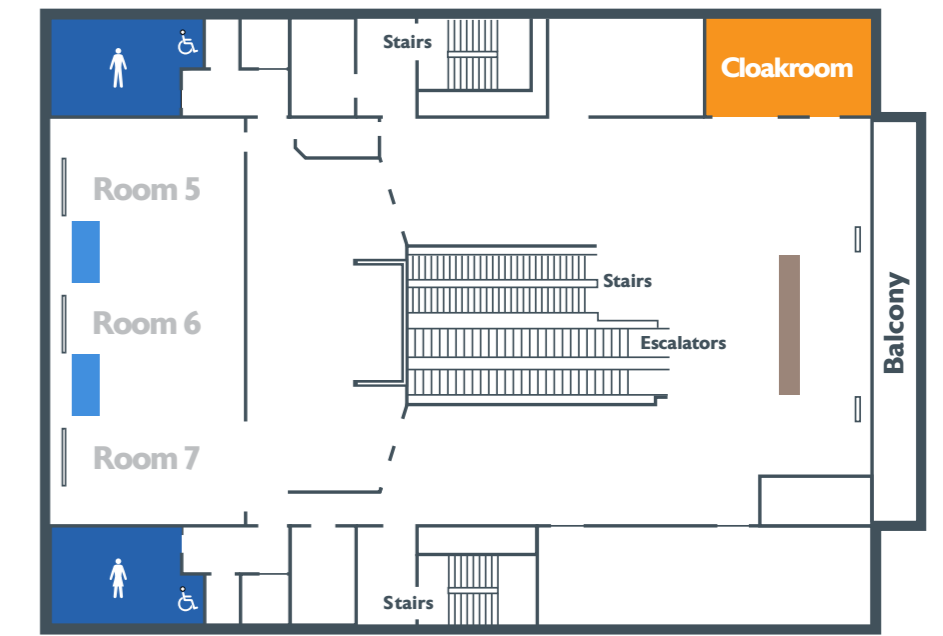

Platinum Suite Level 3

Presentations, Posters, Fringe, Exhibition and

- Posters
- Exhibition
- Catering
- Stage

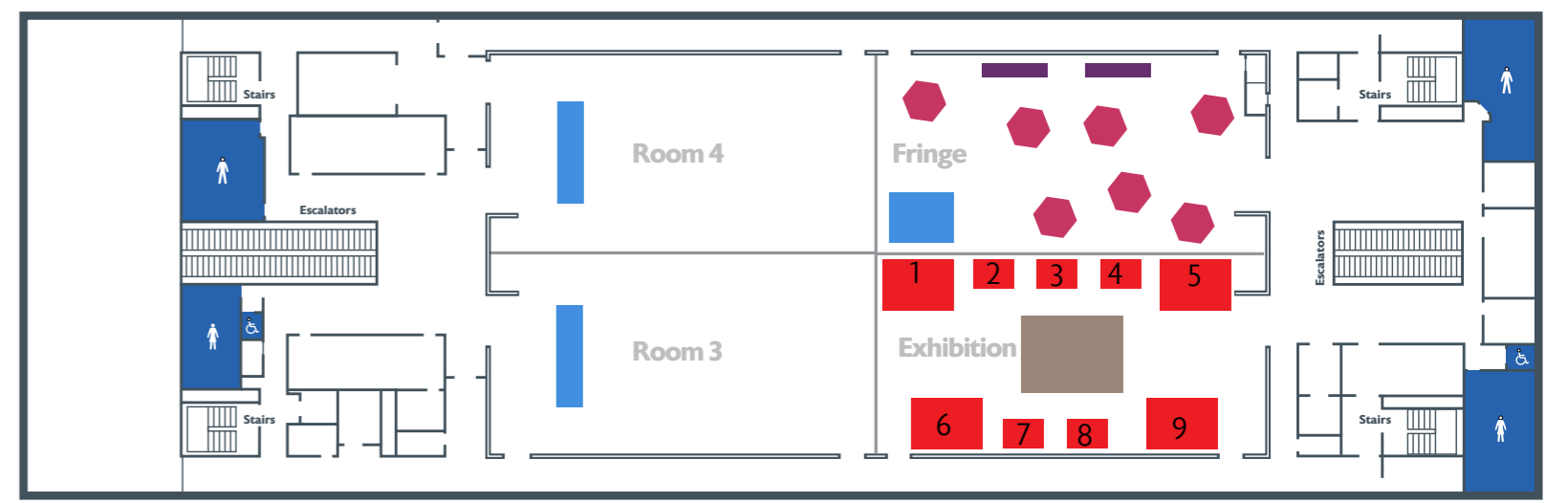



Is proud to present:

Move and Groove: an intergenerational programme
using the power of music and sport to impact on
connection, physical health and mental wellbeing

Wednesday 16th November 2022, 16.30 – 17.00
Room 3



Charlotte Miller
Director of Intergenerational Music Making,
Clinical Early Intervention Specialist Music Therapist, NHS



Introduced by:
Dr Zoe Wyrko
Wellbeing Director, Riverstone



riverstoneliving.com
imm-music.com/move-and-groove



British Geriatrics Society
Improving healthcare
for older people

Marjory Warren House
31 St John's Square
London EC1M 4DN

Telephone +44 (0)20 7608 1369
Fax +44 (0)20 7608 1041
Email communications@bgs.org.uk
Website www.bgs.org.uk